

Figure 1-1 Burial locations in the Near Eastern Societies

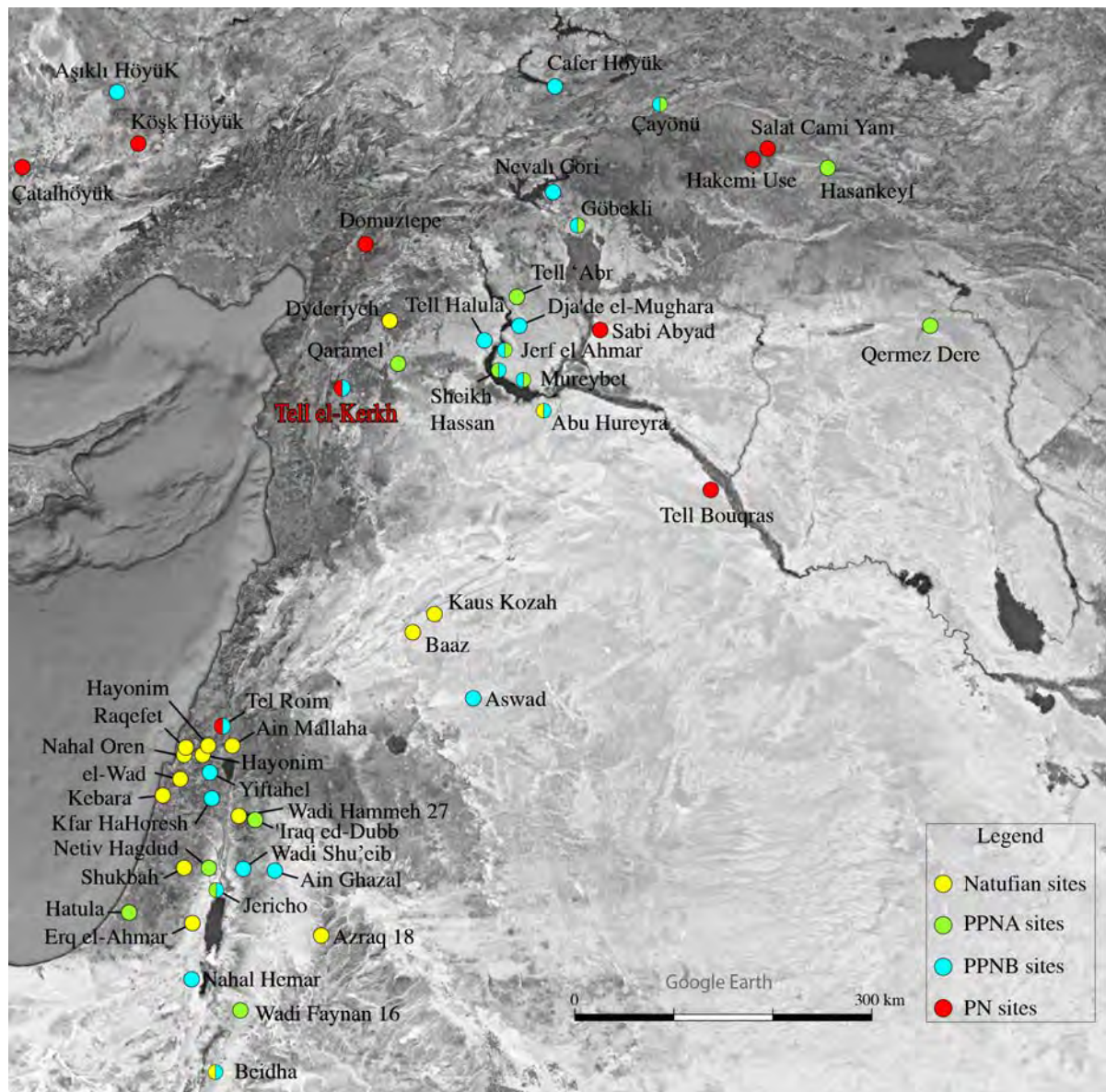

Figure 2-1 General map showing location of the sites mentioned in the text

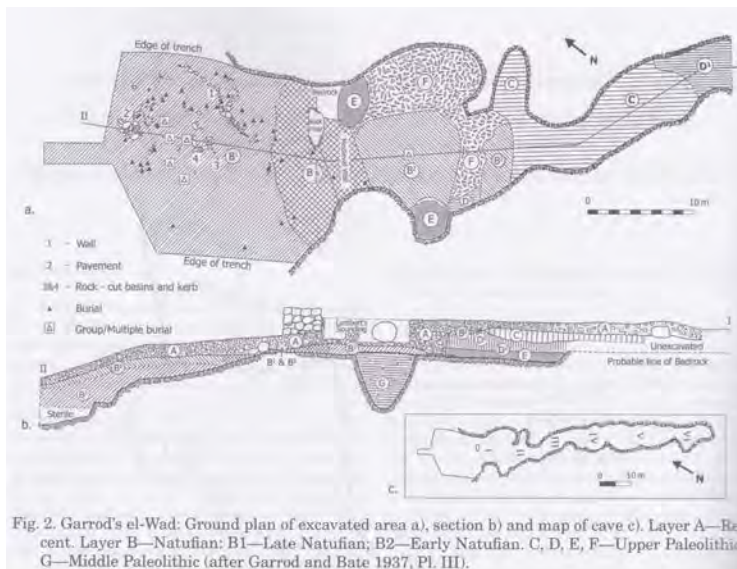
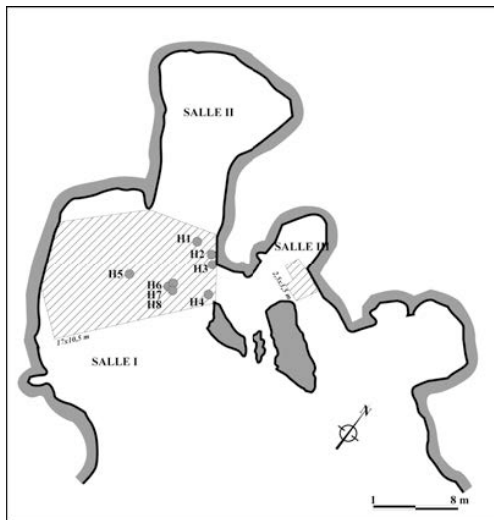





Figure 2-4 Nahal Oren Late Natufian graveyard (Nadel et al. 2012, Fig. 4, p. 82)

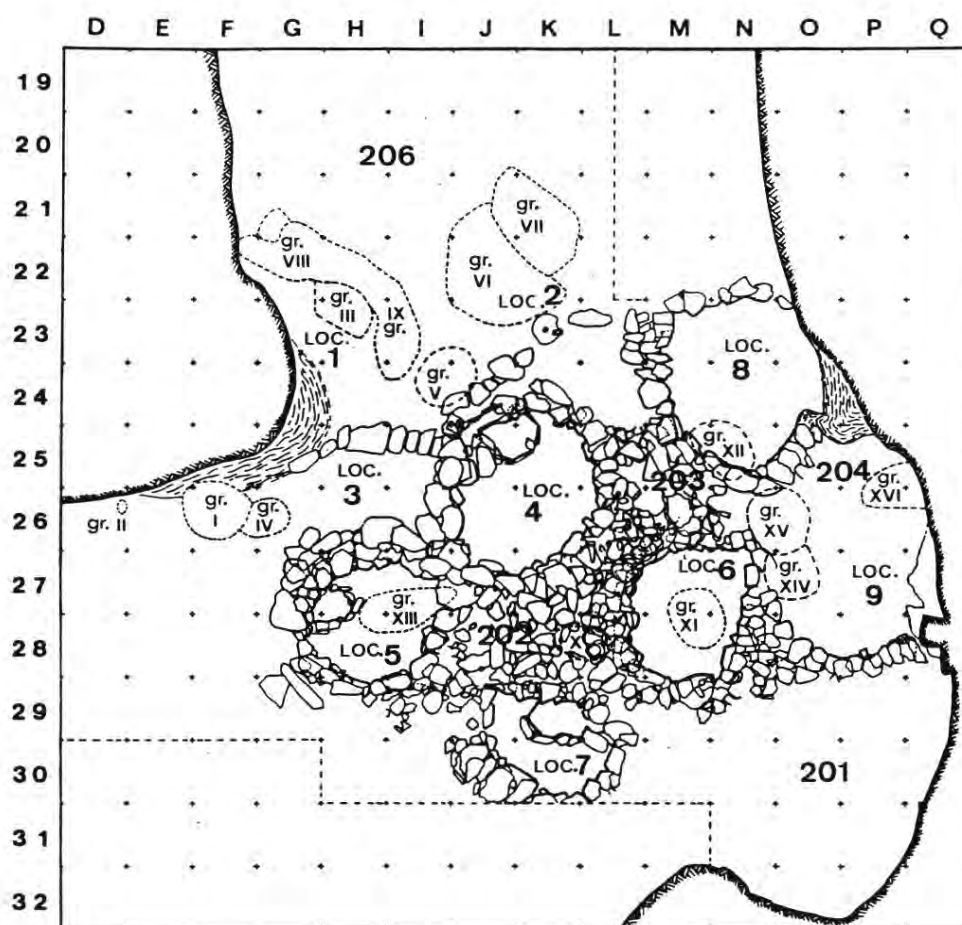

Figure 2-5 The Natufian graveyard in Hayonim Cave (Belfer-Cohen 1988, Fig. 1, p. 298)

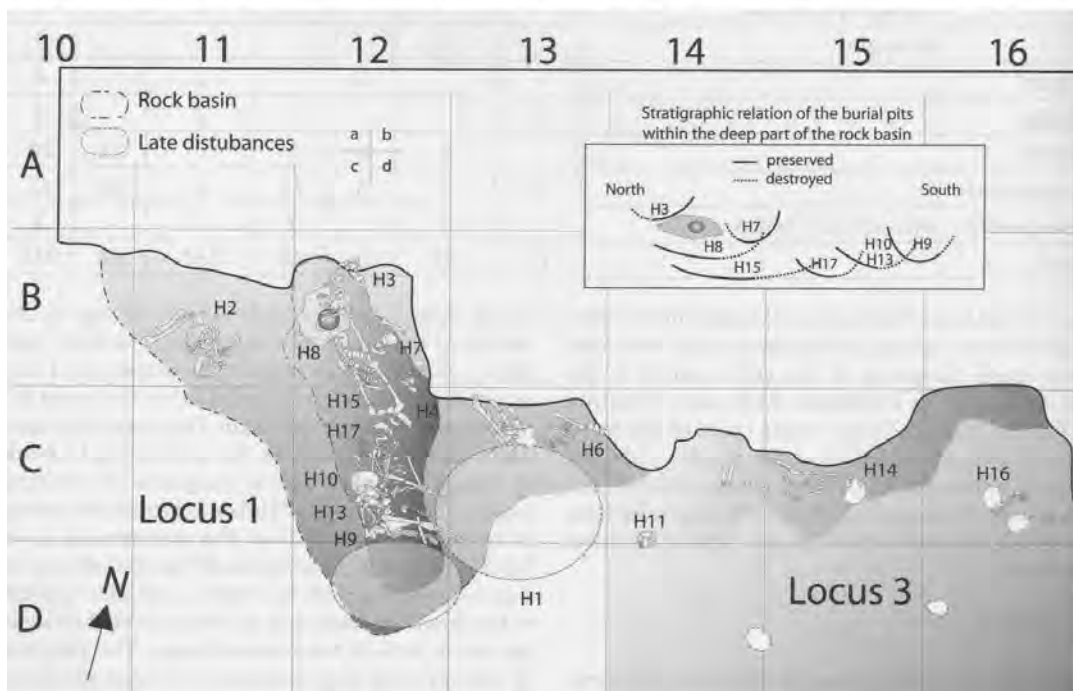
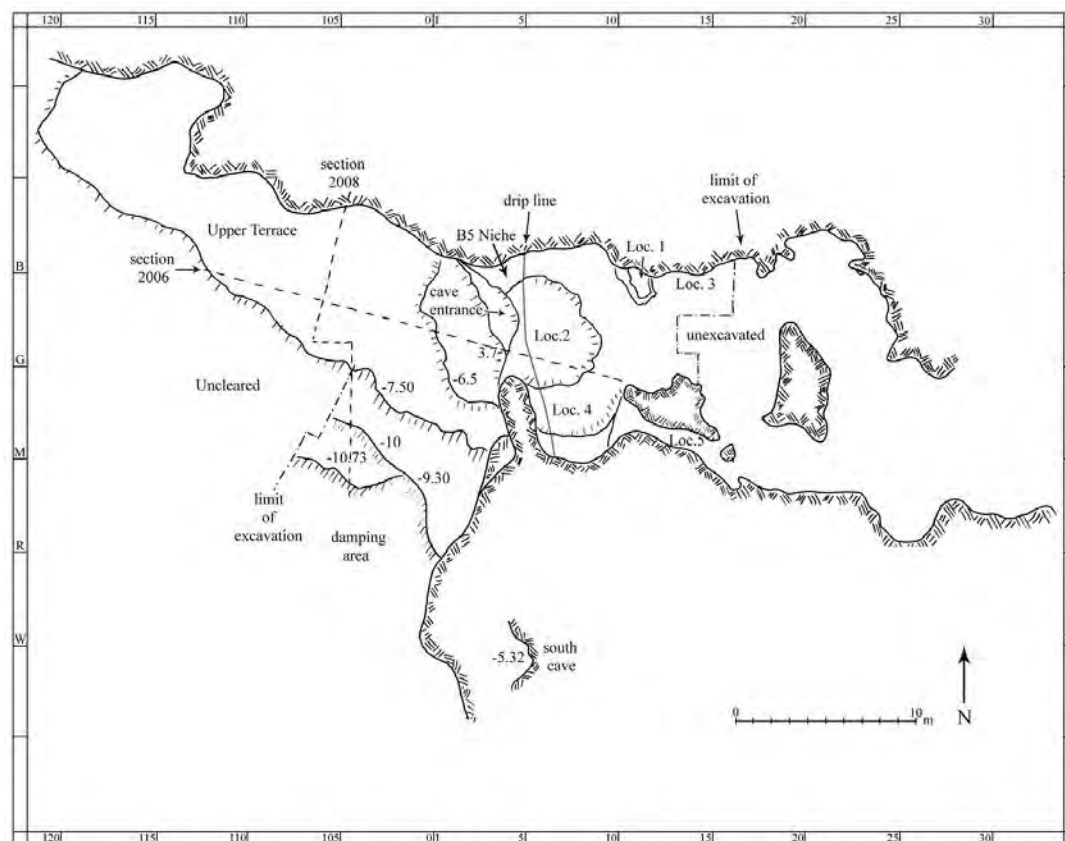

Figure 2-6 Raqefet Cave plan and burials location (Lengyel, Nadel and Bocquentin 2013)

Upper: Raqefet Cave plan (Lengyel, Nadel and Bocquentin 2013, Fig. 2, p. 480).

Lower: Location of human burials at loci 1 and 3 (ibid., Fig. 7, p. 488).

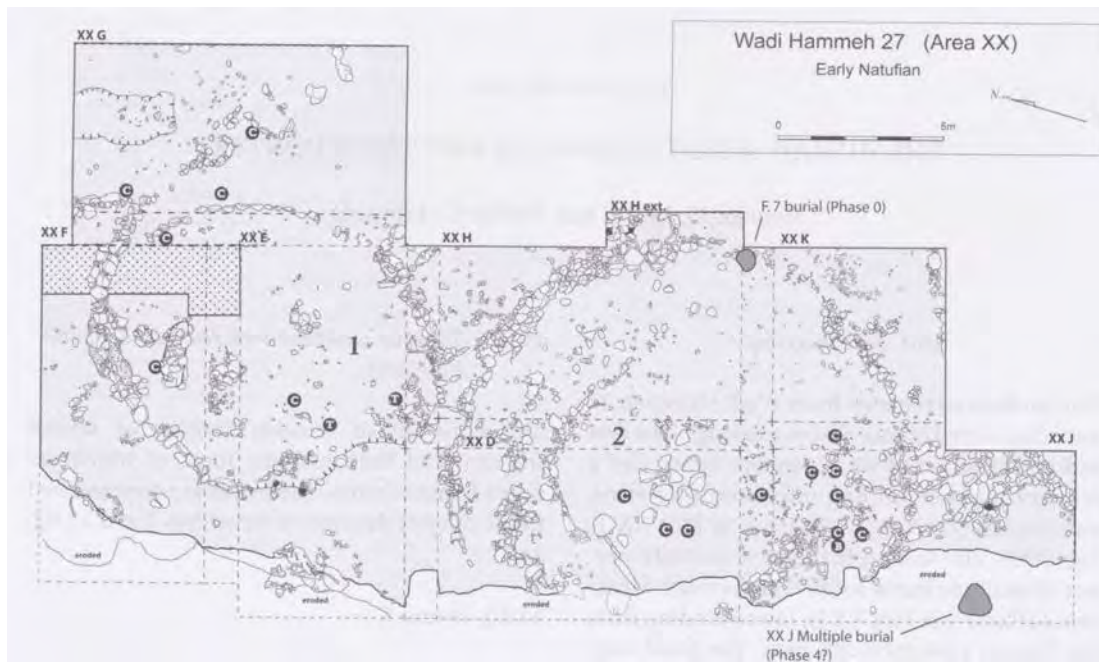

Fig. 15.1. The Main excavation area at Wadi Hammeh 27, indicating the locations of human skeletal material in Phase 0 and Phase 1. The dotted area indicates the Plot XX F sondage. The lettered black discs indicate the locations of human cranial (C), tooth (T) and bone (B) fragments.

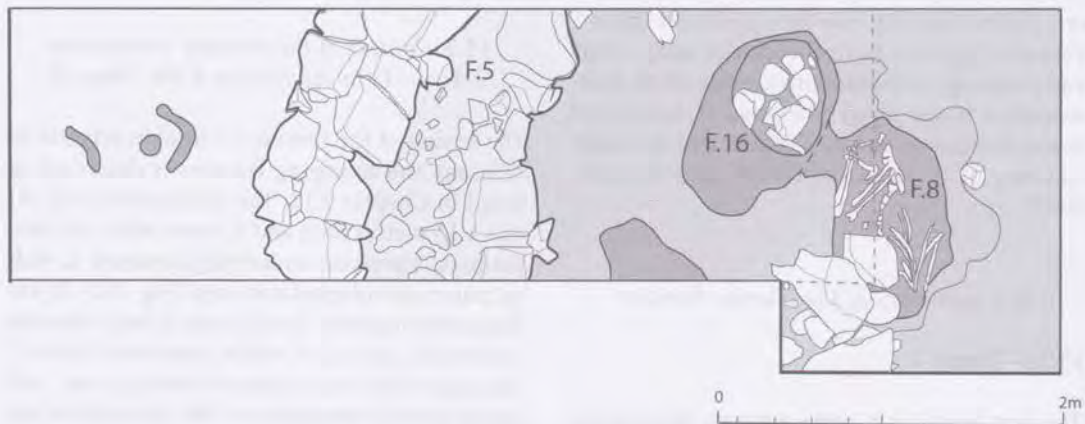

Fig. 15.2. The excavated surface of Phase 4 (grey shaded areas), including the *Homo 1* burial (F. 8) and the associated pit (F. 16) with its basal layer of stones. The dashed gray lines indicate the original extent of the Plot X F sondage before it was enlarged to extricate *Homo 1*.

Figure 2-7 Excavation area at Wadi Hammeh 27 showing the location of burials (Webb and Edwards 2013, Fig. 15. 1, 2, p.368)



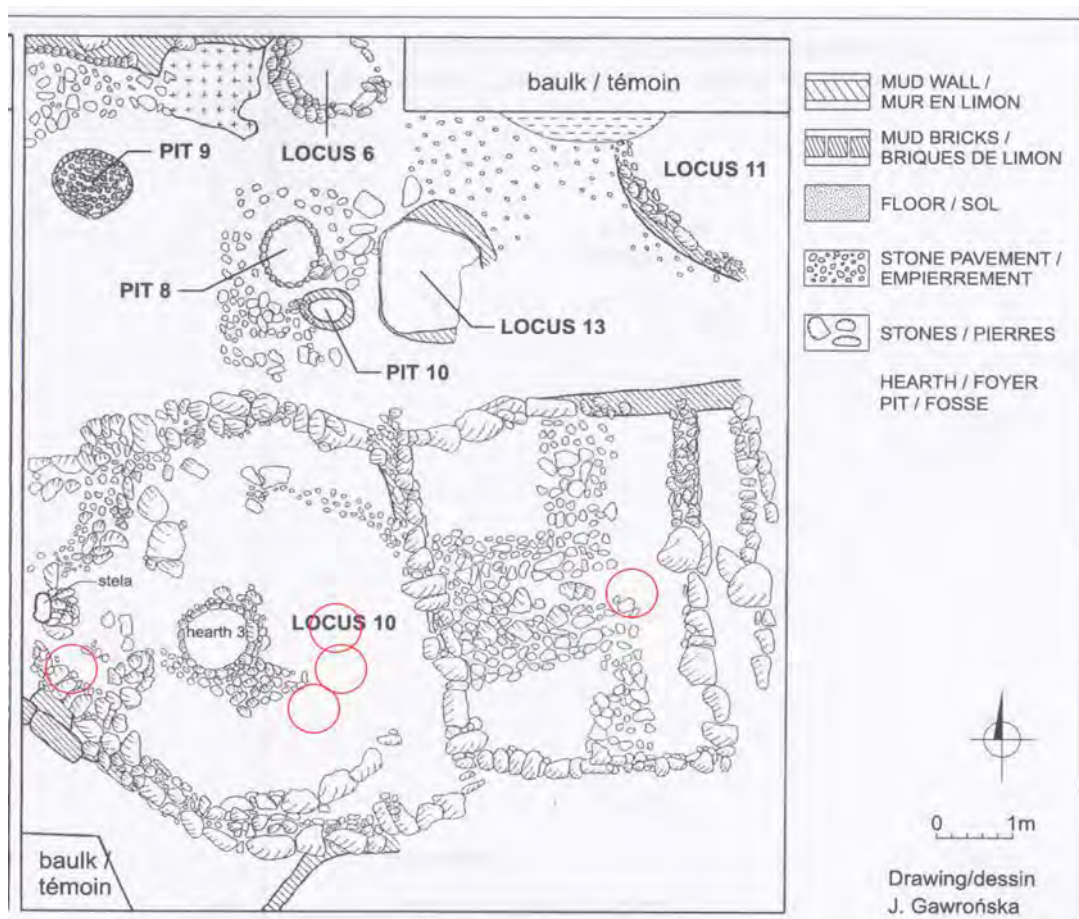

Figure 2-8 Burial locations in the Shrine/Communal house at Tell Qaramel (Mazurowski and Kanjou, eds. 2012, Pl. 37, p. 182).



Figure 2-9 Göbekli Tepe Enclosure C (Schmidt 2010, Fig. 22, p. 251)

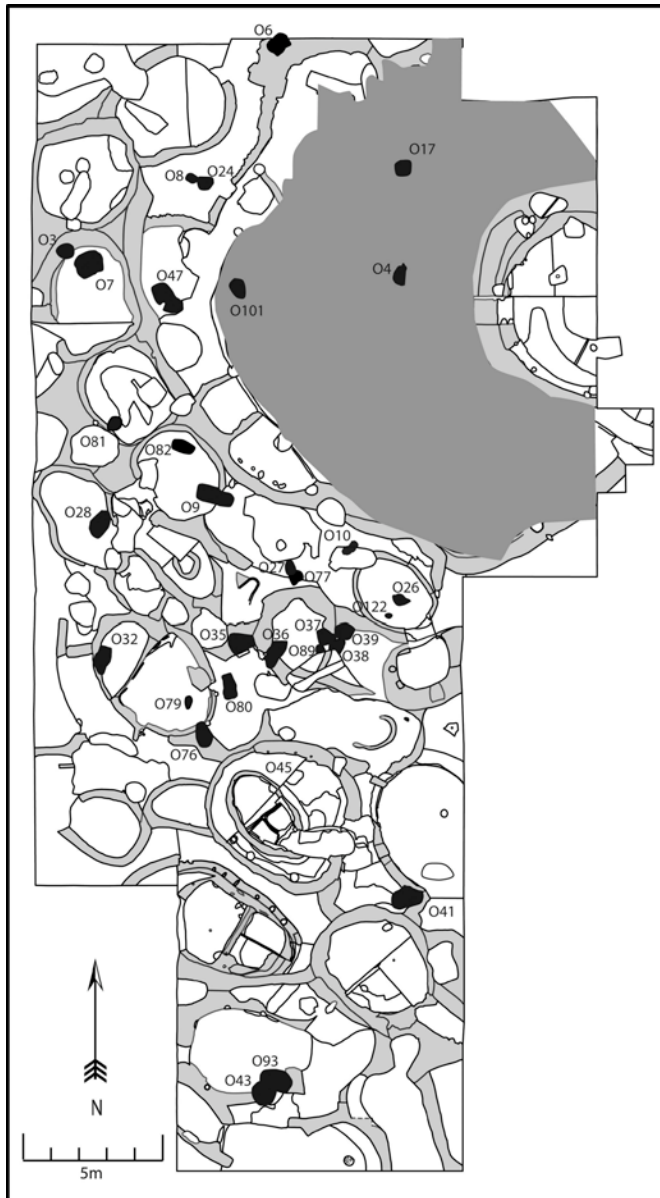

Figure 2-10 Distribution of burials at WF16 (Mithen et al. 2016, Fig. 6.5, p. 90)

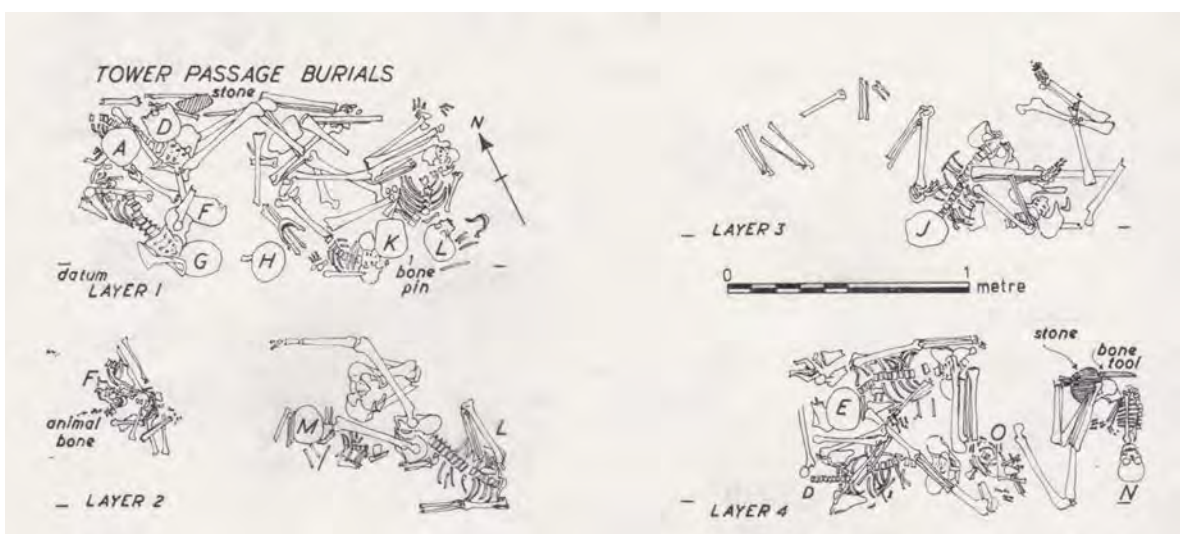

Figure 2-11 PPN Tower burials at Jericho (Cornwall 1981, Fig. 17, p. 406)



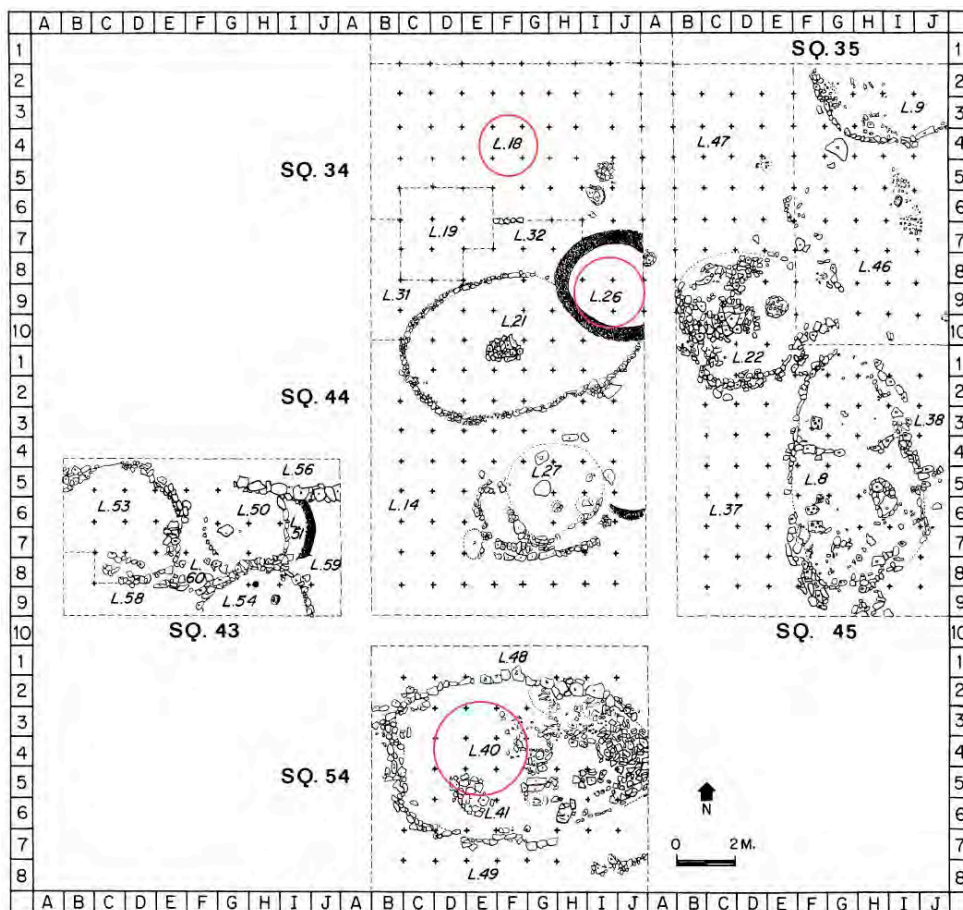

Figure 2-12 Burials location at Netiv Hagdud (Bar-Yosef et al. 1991, Fig. 2, p. 407)

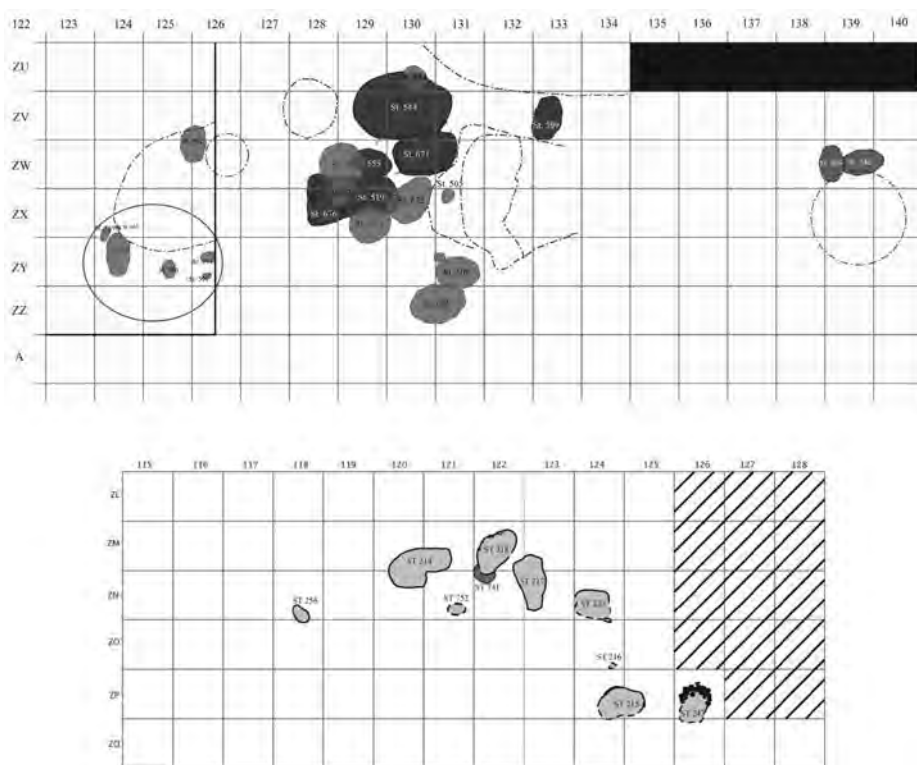

Figure 2-13 Funerary areas at Tell Aswad (Stordeur and Khawam 2007, Fig. 1, p. 24)

Upper: The old funerary area.  
Lower: Recent funerary area.





Figure 2-14 Distribution of the burial contexts (BC) in Area 1 at Tell Qarassa North (Santana et al. 2015, Fig. 2, p. 115).

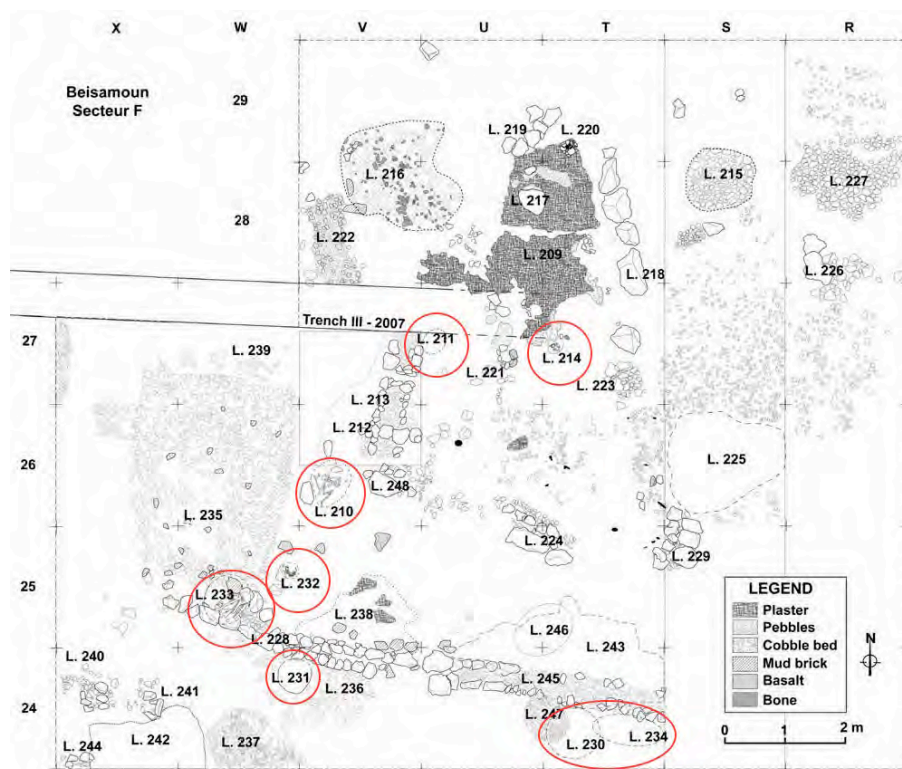

Figure 2-15 General plan of Sector F in Beisamoun showing the location of burials (Bocquentin et al. 2014, Fig. 11, p. 21)

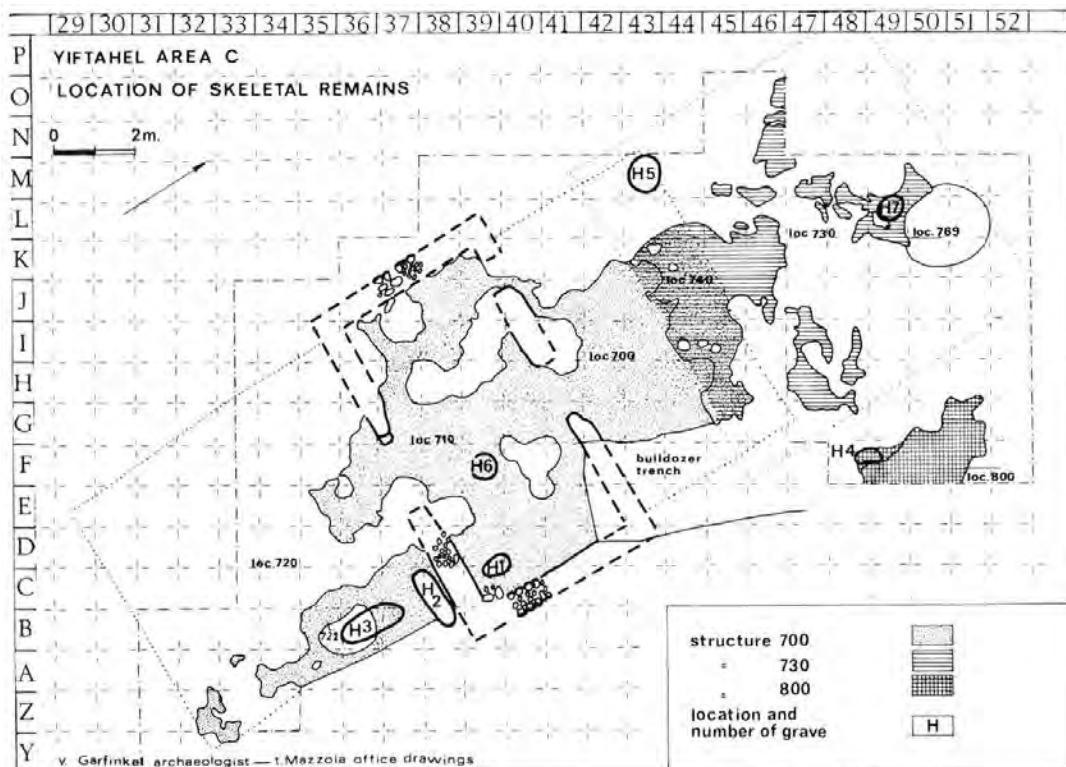

Figure 2-16 A map of Area C at Yiftahel showing the location of burials (Arensburg, Garfinkel and Hershkovitz 1986, Fig. 2, p.74)

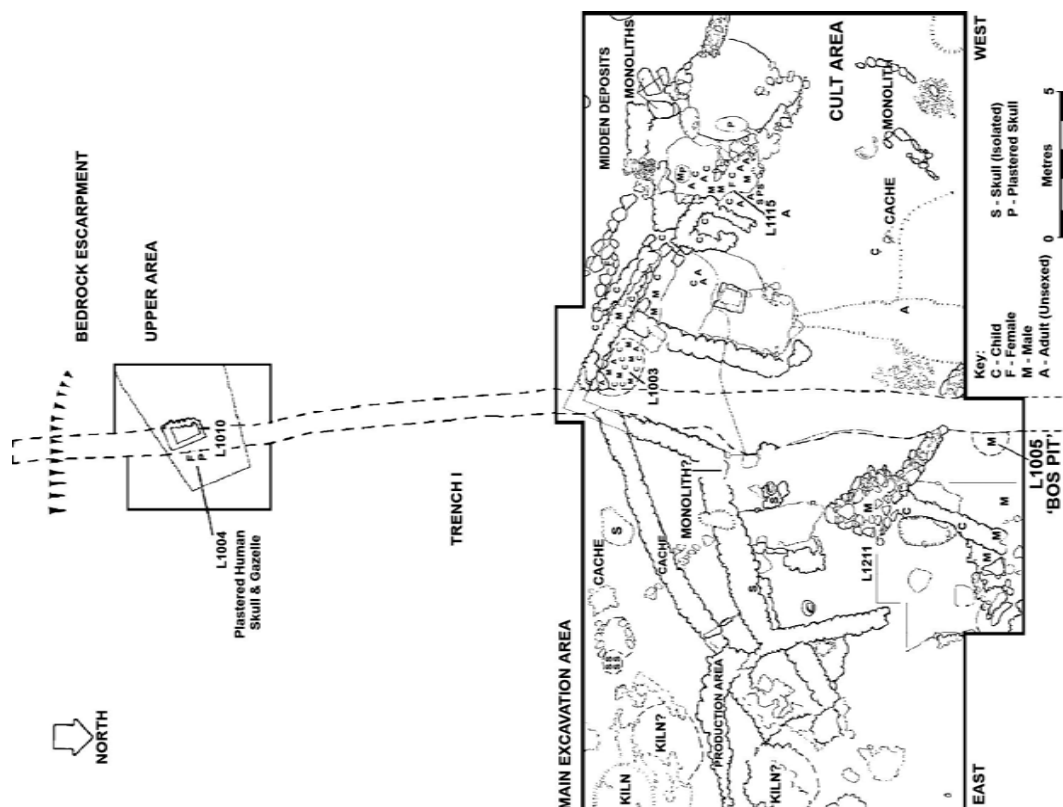

Figure 2-17 Location of the graves and funerary area at Kfar HaHoresh (Goring-Morris and Horwitz 2007, Fig. 2, p. 905)





Figure 2-18 Sort of burial at MPPNB `Ain Ghazal (Rollefson and Kafafi 2013)

Left: An MPPNB subfloor burial (Rollefson and Kafafi 2013, Fig. 1.1.12, p. 14).

Right: A "trash burial" from the later MPPNB period (Rollefson and Kafafi 2013, Fig. 1.1.13, p. 15).

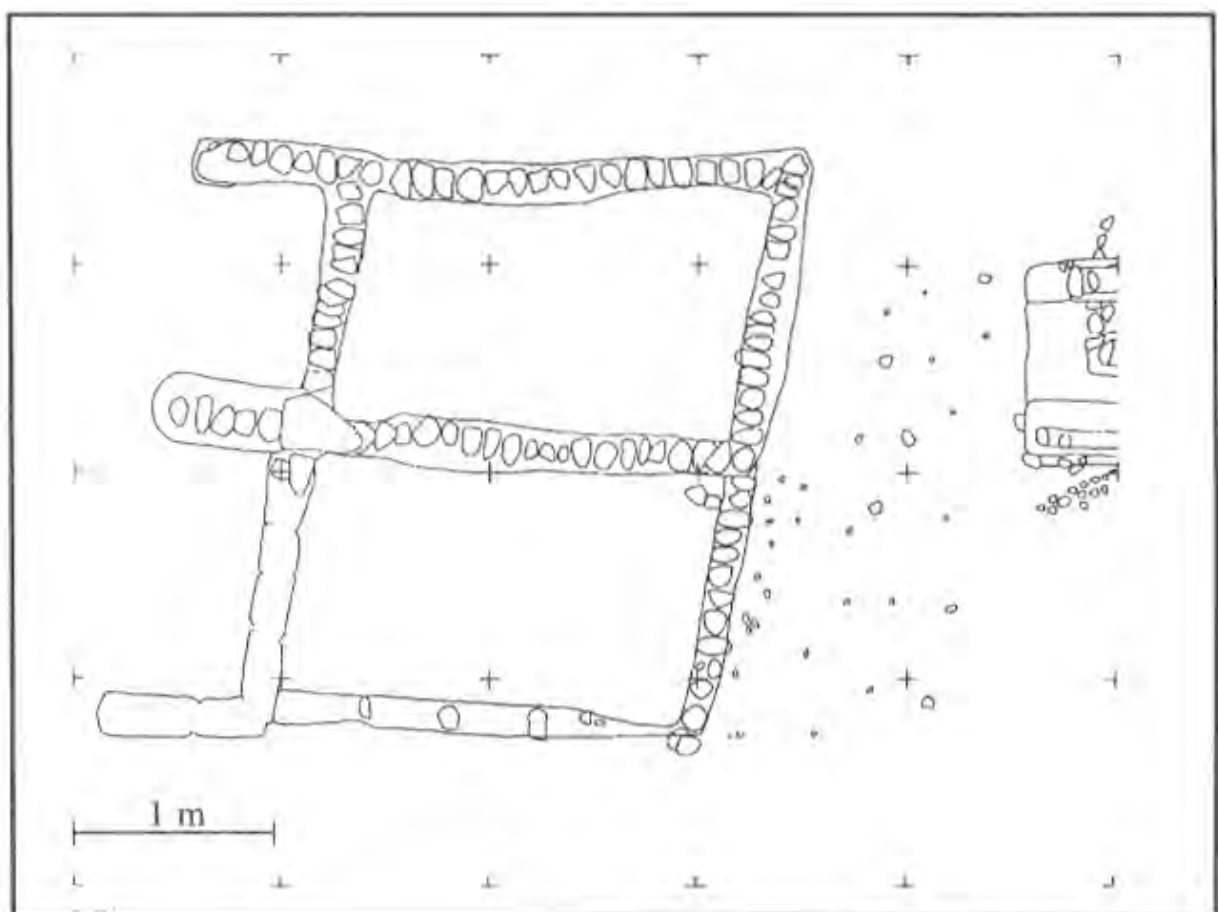

Figure 2-19 Dja'de el-Mughara (Late PPNB) last stage of the "House of the Dead" (Coqueugniot 1998, Fig. 1, p. 111)

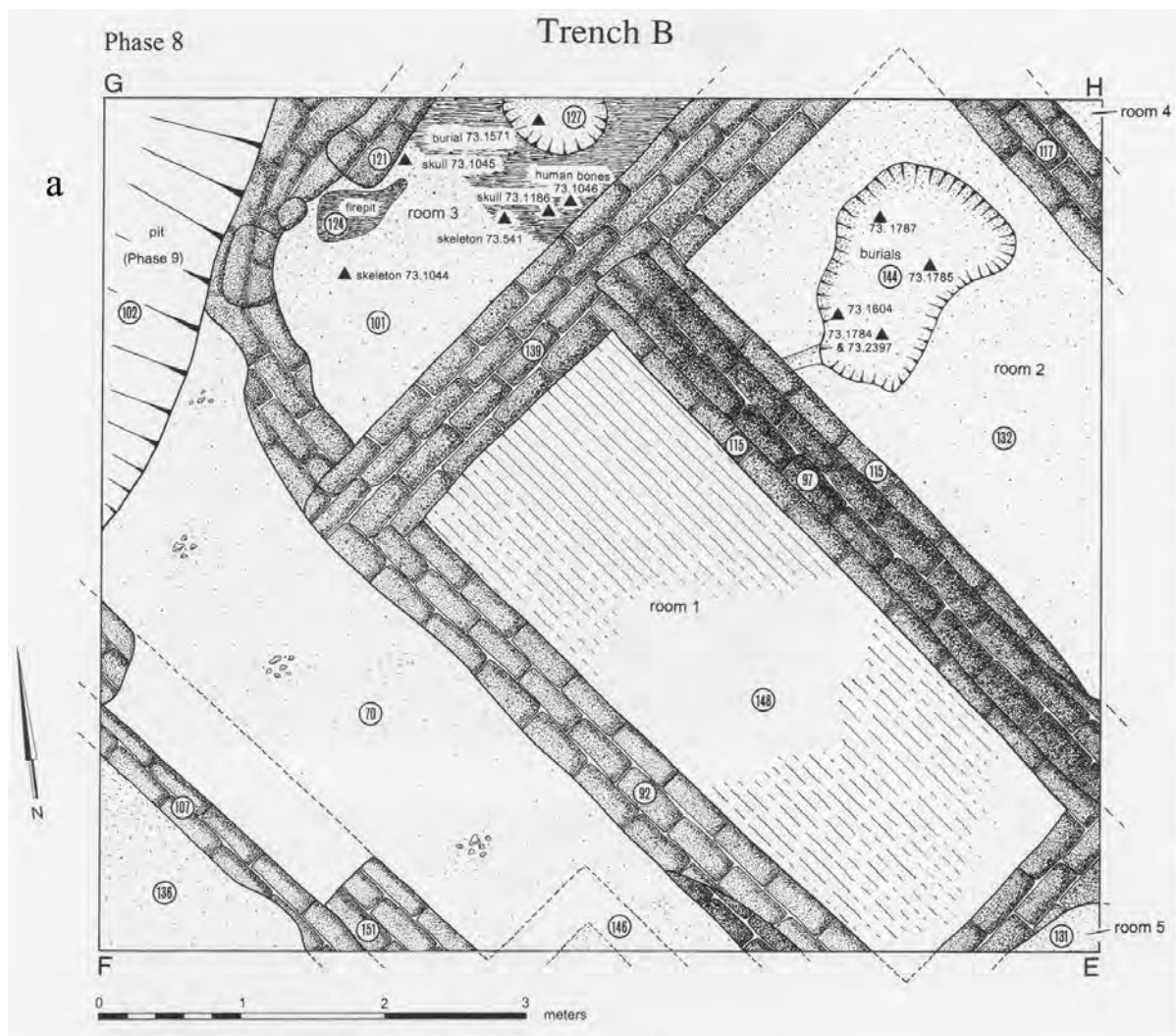

Figure 2-20 Tell Abu Hureyra (Moore and Molleson 2000)

- a. Drawing of phase 8 structure (Moore and Molleson 2000, Fig. 8.17, p. 205).
- b. Phase 8 building from the southeast room (Moore and Molleson 2000, Fig. 8.18, p. 206).
- c. Phase 8 building showing Pit 144 and Charnel room (Moore and Molleson 2000, Fig. 8.19, p. 205).





Figure 2-21 Çayönü Skull Building (Özdoğan 1999)

Left: Çayönü Skull Building: round plan of BM1 and rectangular of BM2 (Özdoğan 1999 (Plates), Fig. 21, p. 26).  
Right: Burial pit in BM1 (ibid 1999, (Plates) Fig. 22, p. 26).